

# Hamstead Hornet

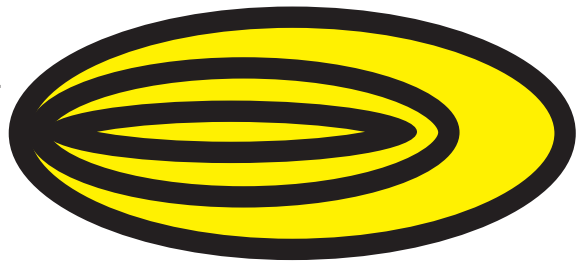

Issue no. 92

Hamstead Marshall's quarterly newspaper  
published since 1996

December 2019

## Yard sale at Elm Farm 4 - 8pm Thur 12th December

The Organic Research Centre is planning to leave Hamstead Marshall in the new year, and is to hold a yard sale of items including unwanted furniture and equipment from the offices and farmhouse. Dr Bruce Pearce, director of research and innovation, made the following announcement on 4th December:

*"We are looking to pass these onto to worthy parties (for a small donation). Most things will not be able to be taken until the new year but if you think you would be interested in putting your name against something please come along to Elm Farm between 4pm and 8pm on the 12th December and take a look."*

**Your local polling station for the general election on Thursday 12th December is the village hall, and it will be open from 7am until 10pm.**

**Newbury constituency's former MP Richard Benyon is not standing for re-election, but information on the constituency and the five new candidates can be seen on <https://www.bbc.co.uk/news/politics/constituencies/E14000830> and <https://www.readingchronicle.co.uk/news/18031784.general-election-candidates-newbury-nbsp/>**

## Elm Farm land sales nearing completion

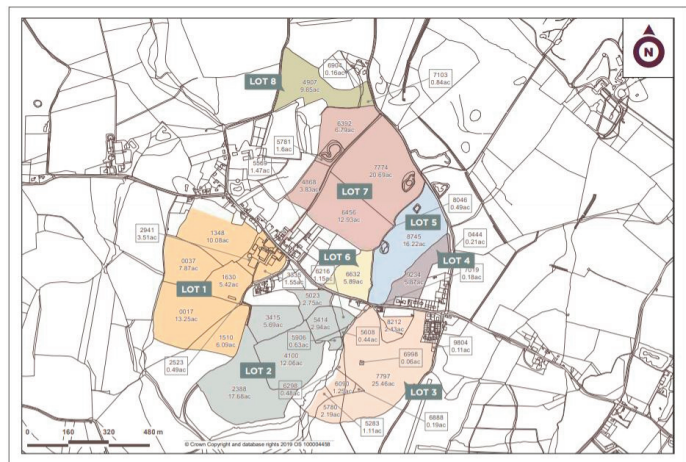

According to Carter Jonas' website on 3rd December the disposal of Elm Farm land is progressing as follows:

- lot 1 is under offer
- lots 2 & 6 have been sold
- lot 3 is under offer
- lot 4 has been sold
- lot 5 is under offer
- lot 7 is under offer
- lot 8 is under offer

Two of the sales are known to have been made to local residents. Lot 8, described as "under offer" appears to have been completed, insofar as horses are now grazing on site, and they are believed to be the horses which draw the tourist narrowboat which plies between Kintbury and Hamstead Marshall each summer. Carter Jonas' "under offer" sign has been uprooted.

## A new house in the village?

An application has been made for permission to build a new, three-bedroom dwelling near the cattle unit at the top of the road running north from Chapel Corner.\*

The applicant, livestock farmers E & DG Stevens, say it is needed for a herdsman. E & DG Stevens has been based at Kintbury Holt Farm since 1966 and currently operates three local units, Highlands, Barrs and Blandys farms. It also runs a dairy unit in Lechlade.

The parish council is objecting because it believes not enough evidence of need has been provided in support of the application.

*\*the application somewhat confusingly identifies the site as on "Park Lane", but the accompanying maps and photos indicate that it is in fact on the parallel road, further to the west (sometimes called Warwick Hill), with the cattle unit at the north end. The application details can be seen here.*

# What's on in the village

for St Mary' Church services see [here](#)

<b>Monday afternoons</b>	<b>Chris Turner's oil painting class</b> <i>beginners &amp; improvers</i>	<b>Village hall</b>	<b>Chris Turner</b> <b>01488 658587</b>
<b>12.30-13.30 Tuesdays</b>	<b>Neeta Madahar's lunchtime yoga</b>	<b>Village hall</b>	<b>Neeta Madahar</b> <b>07906 752620</b>
<b>17.00-22.00 Fridays</b>	<b>White Hart bar open</b> <i>real ales &amp; food</i>	<b>White Hart</b>	<b>WH Facebook</b>
<b>19.00-21.30 Thur 5 Dec</b>	<b>Circle of Friends</b> <i>ladies' group £3</i>	<b>Village hall</b>	<b>Sue Watts</b> <b>01488 658932</b>
<b>16.00-20.00 Thu 12 Dec</b>	<b>ORC Elm Farm yard sale</b> <i>see front page</i>	<b>Elm Farm</b>	<b>Bruce Pearce</b>
<b>07.00-22.00 Thu 12 Dec</b>	<b>General election</b>	<b>Polling station</b> <b>Village hall</b>	<b><a href="https://info.west-berks.gov.uk/elecreg">https://info.west-berks.gov.uk/elecreg</a></b>
<b>10.00-14.00 Sat 14 Dec</b>	<b>Christmas Community Market</b> <i>bread, eggs, cheese, preserves, cakes &amp; savouries, beer, chocolate, jewellery, scarves &amp; bags, tiles, toiletries, cards, toys, children's clothes</i>	<b>Village hall</b>	<b>Lanie Allen</b> <b>01488 658168</b>
<b>19.00 Thu 19 Dec</b>	<b>Village carol singing around Chapel Corner</b>	<b>meet at Chapel Corner post box</b>	<b>Sarah Ward</b>
<b>10.15-10.45 Fri 20 Dec</b>	<b>Mobile library</b>	<b>Ash Tree Grove</b>	<b>WBC mobile libraries</b>
<b>10.30 Thu 9 Jan</b>	<b>Ladies who Brunch</b> <i>booking essential £15</i>	<b>tba</b>	<b>Lanie Allen</b> <b>01488 658168</b>
<b>10.00-13.00 Sat 11 Jan</b>	<b>Community market</b> <i>bread, home-made cakes, eggs, 2nd-hand books, refreshments &amp; good company</i>	<b>Village hall</b>	<b>Lanie Allen</b> <b>01488 658168</b>
<b>10.15-10.45 Thu 16 Jan</b>	<b>Mobile library</b>	<b>Ash Tree Grove</b>	<b>WBC mobile libraries</b>
<b>19.30-21.30 Wed 22 Jan</b>	<b>Speaker's Corner:</b> <b>Alistair Mills on Robert Burns</b>	<b>St Mary's Church</b>	<b>Venetia Dunlop</b>
<b>10.15-10.45 Thu 6 Feb</b>	<b>Mobile library</b>	<b>Ash Tree Grove</b>	<b>Lanie Allen</b>
<b>19.00-21.30 Thu 6 Feb</b>	<b>Circle of Friends</b> <i>ladies' group £3</i>	<b>Village hall</b>	<b>Sue Watts</b> <b>01488 658932</b>
<b>10.00-13.00 Sat 8 Feb</b>	<b>Community market</b> <i>bread, home-made cakes, eggs, 2nd-hand books, refreshments &amp; good company</i>	<b>Village hall</b>	<b>Lanie Allen</b> <b>01488n 658168</b>
<b>10.30 Thu 13 Feb</b>	<b>Ladies who Brunch</b> <i>booking essential £15</i>	<b>tba</b>	<b>Lanie Allen</b> <b>01488 658168</b>
<b>19.30-21.30 Thu 13 Feb</b>	<b>Speaker's Corner:</b> <b>Chris Bullard on Life in the Ocean Wave</b>	<b>St Mary's Church</b>	<b>Venetia Dunlop</b>
<b>10.15-10.45 Thu 27 Feb</b>	<b>Mobile library</b>	<b>Ash Tree Grove</b>	<b>WBC mobile libraries</b>
<b>19.00-21.30 Thu 5 Mar</b>	<b>Circle of Friends</b> <i>ladies' group £3</i>	<b>Village hall</b>	<b>Sue Watts</b> <b>01488 658932</b>
<b>19.30-21.30 Tue 10 Mar</b>	<b>Speaker's Corner:</b> <b>Jim Flint on Mid-Atlantic Village</b>	<b>St Mary's Church</b>	<b>Venetia Dunlop</b>
<b>10.30 Thu 12 Mar</b>	<b>Ladies who Brunch</b> <i>booking essential £15</i>	<b>tba</b>	<b>Lanie Allen</b> <b>01488 658168</b>
<b>10.00-13.00 Sat 14 Mar</b>	<b>Community market</b> <i>bread, home-made cakes, eggs, 2nd-hand books, refreshments &amp; good company</i>	<b>Village hall</b>	<b>Lanie Allen</b> <b>01488n 658168</b>
<b>10.15-10.45 Thu 19 Mar</b>	<b>Mobile library</b>	<b>Ash Tree Grove</b>	<b>WBC mobile libraries</b>

## Planning applications taken from <https://publicaccess.westberks.gov.uk> on 4th December 2019. To see more details visit this site and search on the application number.

### APPROVED

#### 43 Hamstead Marshall, RG20 oHP

19/02352/HOUSE validated 23rd Sept 2019  
Demolish existing garage to make way for proposed two storey side extension and single storey side extension. Internal alterations to existing house. New carport with modifications to access and car parking arrangements.  
Approved 18th Nov 2019

#### Morewood House, RG20 oJD

19/02286/LBC2 validated 19th Sept 2019  
Strip and re-tile W elevation of the garage roof.  
Approved 14th Nov 2019

#### Former Shooting Lodge, Hamstead Park RG20 oHE

19/02227/CERTE validated 5th Sept 2019  
Continued use of former shooting lodge as a dwelling.  
Approved 22nd Nov 2019

#### Site of former Park Lodge

19/01928/COND1 validated 1st Aug 2019  
Approval of details reserved by Conditions 5 - Materials, 6 - Eaves and fascias and 7 - Landscaping of approved application 18/00845/FUL.  
Approved 25th Sept 2019

#### Hamstead Park, RG20 oHE

19/02472/CERTE validated 8th Oct 2019  
The stationing of a caravan within residential curtilage to be used as ancillary staff accommodation.  
Approved 14th Nov 2019

### REFUSED

#### 9 Salters RG20 oHH

19/01624/HOUSE validated 20th Jun 2019  
Proposed two-storey side and rear extension to house. Demolish garage and summer house and erect new detached timber frame garage  
Refused 31st Oct 2019 on grounds of scale, sensitivity of location, and bats.

### AWAITING DECISION

#### Craven House, RG20 oJG

19/02502/FULMAJ validated 10th Oct 2019  
Proposed amendments to approved application 18/01267/HOUSE for the erection of single storey extensions, pool hall structure, alterations to external elevations, creation of leisure facilities, demolition of existing single-storey canopy structure and greenhouse. Amendments include a) widening of the pool house to extend by a further 2 metres to the south and b) changes to the external appearance of north, south and east elevations, removing the dressed stone features of the approved scheme, with a large glazed sliding door.

#### Land west of Park Lane

19/02274/FULD validated 31st Oct 2019  
Erection of rural workers dwelling for key worker. Objection from Hamstead Marshall Parish Council. (See front page.)

#### 4 Hamstead Mill RG20 oJD

19/02902/LBC2 validated 21st Nov 2019  
Proposed internal alterations to floor plans, new kitchen and bathroom layouts, new stairs to 2nd floor, alterations to stairs on ground floor, new mechanical and electrical installations and up-grading fire separation in basement area.

#### Cross Boundary

19/02818/FORMB validated 6th Nov 2019  
Planning Notification Form related to the Electricity Act 1989: Overhead Lines (Exemption) (England & Wales) Regulations 2009. For new and replacement poles.

#### Enborne Equestrian Centre, Holtwood, RG20 oJL

17/02878/FULD validated 18th Oct 2017  
Section 73A: Variation of Conditions 3, 4, 5 & 7 of planning permission reference 16/00775/FULD (Proposed dwelling to replace existing mobile home) No objection from parish council. (No apparent additional documentation 2019.)

## Speaker's Corner

**continues at St Mary's Church once a month  
all are welcome**

**entrance £5 includes a glass of wine/soft drink and nibbles**

**see [www.hamsteadmarshall.net/noticeboard](http://www.hamsteadmarshall.net/noticeboard) for speakers  
or email Venetia Dunlop for details**

# Christmas Community Market at the village hall

## 10 till 2, Sat 14th December

*lots of seasonal treats and goodies*



## News in brief

Lanie Allen sends **thanks to the bonfire builders**, pyrotechnicians, cooks, bar workers, bucket-shakers and clearer-uppers for their hard work on Bonfire Night and the weekend before. £605 and 1 euro was raised, topping the record for village bonfire collections, and is for the Alexander Devine Hospice.

It's Chapel Corner's turn to be serenaded by the **village carol singers** this year, on Thursday 19th December. If you would like to join them, be at the Chapel Corner post box at 7pm, well wrapped up and equipped with a torch. Carollers can usually expect a hospitable welcome from residents.

Neeta Madahar welcomes newcomers to her **Lunchtime Yoga** sessions in the village hall from 12.30 to 1.30pm on Tuesdays. The cost is £9 per session with a discount card, or £11 for drop-in.

**Holtwood Corner** continues to be offered for sale by Knight Frank at a guide price of £3,750,000.

WBC has announced the closure of Watery Lane between 8am and 4pm on Monday 9th December, although the attached map indicates that the **closure applies to the Holtwood road between Watery Lane and Red Hill.**

Two public meetings were held earlier in the autumn to consider **the future of St Mary's Church**, and the topic was the main item on the agenda of the PCC meeting in late October. Discussions are continuing, and a second PCC meeting is scheduled for January, at which the new arch-deacon for Berkshire, the Rev Canon Stephen Pullin, is expected to attend.

The **draft parish plan** has recently been updated, and has gone back to WBC, where it is awaiting approval.

When approved, it is hoped that the plan will qualify for funding to carry out the work, in particular, replacement of play equipment in the hall field, but the village may have to match-fund.

The White Hart, which closed yet again a few weeks ago, has re-opened for an experimental series of **Friday evenings, from 5 until 10pm.** Saviour Brewery ales are on offer and a food truck is in attendance from 6.30 to 8.30.

The owner's intention is to seek to convert the premises to housing, but to retain the bar if there is sufficient demand and support from villagers. Takings need to be around £900 per session to cover costs and make the sessions worthwhile.

Following a West Berkshire Heritage Forum selection panel held on 27th September, **Hamstead Marshall Village Hall, has been granted local listing.**

*Local listing is designed to ensure that the historic and architectural interest of locally important buildings which do not meet the criteria for being nationally listed, is taken into account by the planning process.*

The hall was built in 1895 as the village school, replacing an earlier nineteenth-century building which had been condemned as inadequate under the 1870 Education Act. The new school was paid for by Mrs James Bishop, who with her husband, rented Hamstead Lodge in the park for several decades until 1913.

At the time, it was not thought necessary to rebuild the adjoining schoolteacher's house, which still dates from the first quarter of the nineteenth century.

**Hall bookings** have held up well since the departure of the Montessori preschool, with artists, astronomers, tai chi-ers, ballroom dancers and young farmers all making regular use of the facilities.

The **new rose hedge along the picket fence**, and the lavender and hellebore plants under the arched window of the village hall were kindly donated by Inga Craven.

### Hamstead Hornet

The *Hamstead Hornet* is published quarterly online at <http://www.hamsteadmarshall.net/social-life/hamstead-hornet/>. Readers who have supplied their email addresses to the editor receive notification with a link as soon as each issue is posted. News stories are updated between issues on <http://www.hamsteadmarshall.net/social-life/noticeboard/>. The *Hamstead Hornet* is edited and published by Penelope Stokes at The Holding, Hamstead Marshall, Newbury, Berks RG20 0HW 01488 658759 [admin@hamsteadmarshall.net](mailto:admin@hamsteadmarshall.net)